



A spacious three bedroom ground floor apartment set in a portered purpose built block opposite Regent's Park The apartment has a spacious well-equipped kitchen. Two reception rooms and two bathrooms. The property is located close to St John's Wood High Street and further benefits form communal heating and hot water.

Viceroy Court

NW8 7PP

£830 Per Week

Subject to Contract

# FOXGREGORY





Viceroy Court Prince Albert Road, London, NW8  
Approximate Gross Internal Floor Area = 120.0 sq m / 1292 sq ft

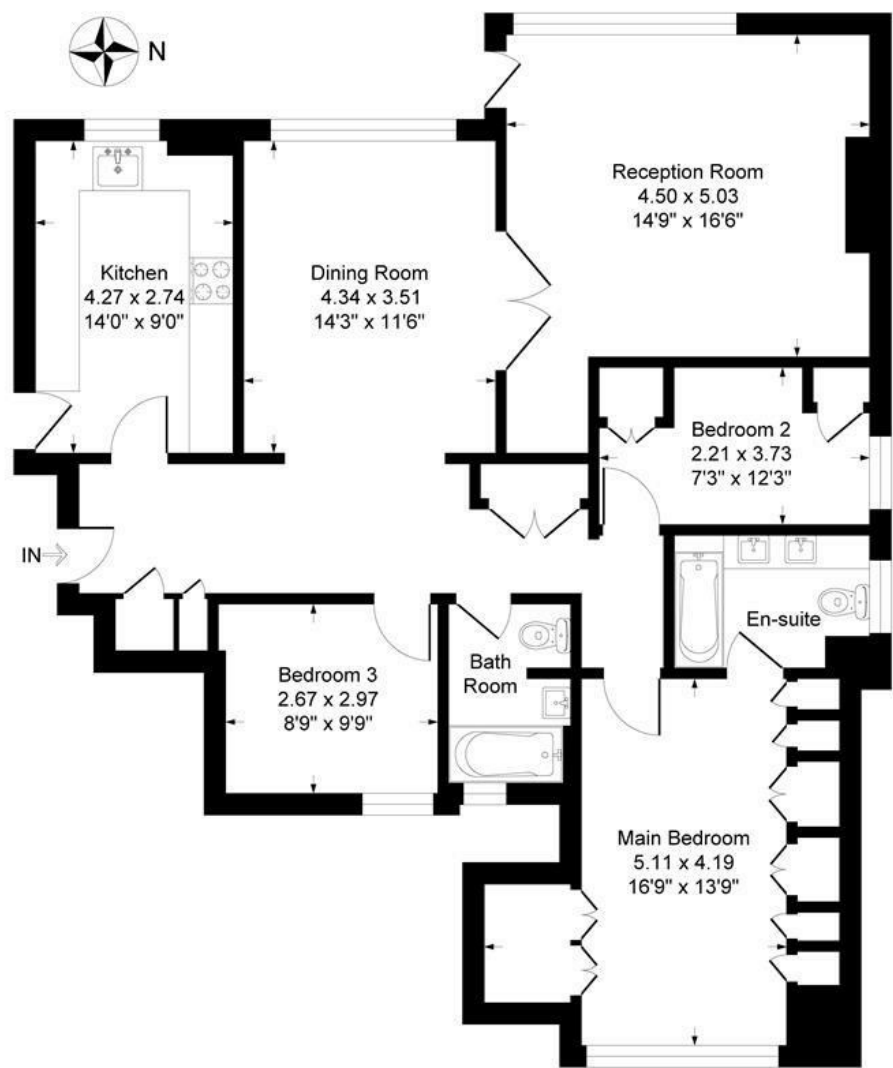

Ground Floor

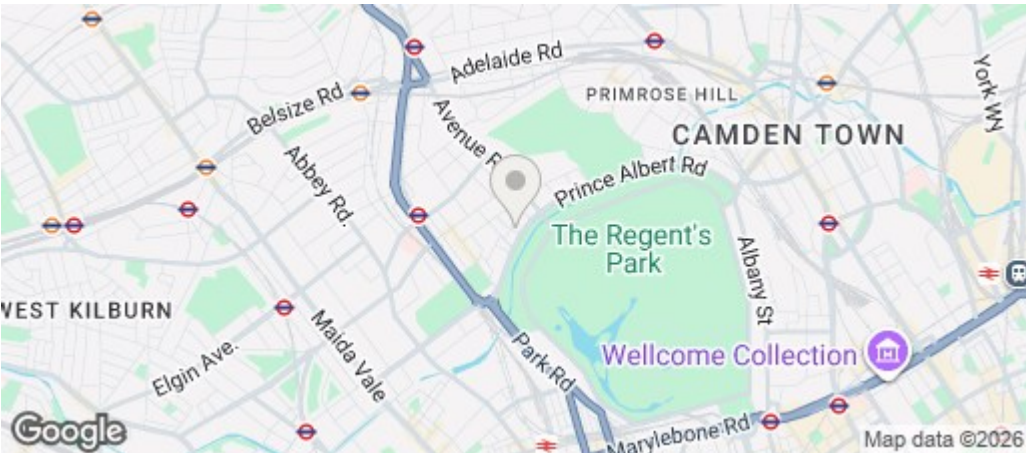

| Energy Efficiency Rating                    |         |                         |
|---|---------|-------------------------|
|   | Current | Potential               |
| Very energy efficient - lower running costs |         |                         |
| (92 plus) A                                 |         |                         |
| (81-91) B                                   |         |                         |
| (69-80) C                                   |         |                         |
| (55-68) D                                   |         |                         |
| (39-54) E                                   | 57      | 76                      |
| (21-38) F                                   |         |                         |
| (1-20) G                                    |         |                         |
| Not energy efficient - higher running costs |         |                         |
| England & Wales                             |         | EU Directive 2002/91/EC |